

Male - Conical Buffers

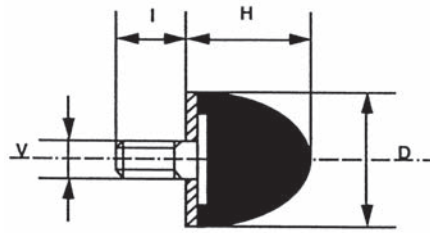

Male Conical Buffers are ideal for absorbing shock. Giving high levels of deformation under impact / load, and provide a progressive stiffness rate to absorb energy and protect equipment. Stainless Steel metals and Oil Resistant / High Temperature rubbers available on request.

Applications include - Primary & secondary suspension for vehicles, bump stops for general industrial machinery, assister springs

PART	D x H	V x I	45 IRHD	60 IRHD	70 IRHD	mm
1010MCB12	10 x 10	M5 x 12	-	-	-	-
2015MCB10	20 x 15	M6 x 10	-	-	-	-
2024MCB18	20 x 24	M6 x 18	-	-	-	-
2425MCB18	24 x 25	M6 x 18	35	51	71	6.25
2514MCB20	25 x 14	M8 x 20	35	50	70	3.5
2516MCB18	25 x 16	M6 x 18	-	-	-	-
3030MCB14	30 x 30	M6 x 14	37.0	54.0	74.0	7.5
3540MCB23	35 x 40	M8 x 23	-	-	-	-
4535MCB23	45 x 35	M8 x 23	96.0	140.0	193.0	7.5
5050MCB25	50 x 50	M10 x 25	117.0	170.0	233.0	12.5
5058MCB20	50 x 58	M8 x 20	147.0	214.0	293.0	15.0
5061MCB28	50 x 61	M8 x 28	-	-	-	-
5064MCB35	50 x 64	M8 x 35	127.0	185.0	253.0	16.0

PART	D x H	V x I	45 IRHD	60 IRHD	70 IRHD	mm
5067MCB33	50 x 67	M8 x 33	-	-	-	-
5068MCB38	50 x 68	M10 x 38	-	-	-	-
6040MCB62	60 x 40	M14 x 62	209.0	305.0	418.0	10.0
6060MCB37	60 x 60	M12 x 37	195.0	286.0	395.0	15.0
7058MCB32	70 x 58	M12 x 32	-	-	-	-
7060MCB35	70 x 60	M12 x 35	210.0	360.0	419.0	14.5
7589MCB37	75 x 89	M12 x 37	-	-	-	-
9580MCB45	95 x 80	M16 x 45	407.0	594.0	814.0	20.0
10095MCB31	100 x 95	M12 x 31	225.0	450.0	680.0	24.0
100100MCB31	100 x 100	M12 x 31	220.0	440.0	660.0	23.0
100120MCB31	100 x 120	M12 x 31	210.0	420.0	630.0	30.0
11877MCB41	118 x 77	M16 x 41	-	-	-	-
3460MCB	70 x 46	M12 x 30	178.0	260.0	356.0	11.5

PART NO.	D	H	G	L
1514MRF04	15	14	M4	13
2024MRF06	20	24	M6	18
2519MRF06	25	19	M6	18
4028MRF08	40	28	M8	10
5028MRF10	50	28	M10	33
7043MRF10	70	43	M10	28
7537MRF12	75	37	M12	37

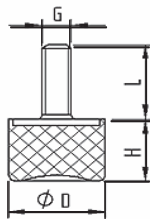

PART NO.	D1	D2	d	H
4223TRB18	42	40	18	23
6233TRB21	62	60	21	33
7233TRB21	72	70	21	33
8240TRB25	82	80	25	40
10254TRB32	102	100	32	54
12246TRB38	122	120	38	46

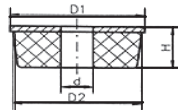

PART NO.	D	H	d1	d2	s
3016PRB09	30	16	16	9	3
4016PRB09	40	16	16	9	3
4020PRB09	40	20	17	9	3
5016PRB11	50	16	20	11	3
5020PRB11	50	20	22	11	3
6020PRB11	60	20	25	11	4
7525PRB13	75	25	30	13	6
8020PRB13	80	20	32	13	4
10025PRB13	100	25	40	13	6
10030PRB33	100	30	60	33	6
12525PRB17	125	25	50	17	6

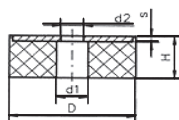

PART NO.	D	H	G	h
1212MCBT10	12	12	M4	10
1406MCBT04	14	6	M4	4
2512MCBT18	25	12	M6	18
2514MCBT10	25	14	M4	10
2517MCBT18	25	17	M6	18
4521MCBT46	45	21	M8	46
5018MCBT28	50	18	M10	28
5020MCBT28	50	20	M10	28
5050MCBT28	50	50	M10	28
8027MCBT37	80	27	M12	37
12545MCBT45	125	45	M16	45

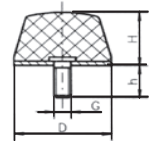

PART NO.	A	B	C	G	H
3835MFBT27	38	30	35	M10	27
4335MFBT27	43	30	35	M10	27
4350MFBT25	43	30	50	M10	25

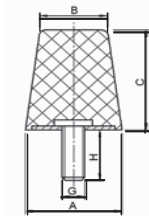

PART NO.	D	H	G	h
2417MCB20	24	17	M8	20
2516MCB20	25	16	M8	20
4024MCB28	40	24	M8	28
5028MCB28	50	28	M8	28
5045MCB35	50	45	M10	35
6045MCB28	60	45	M10	28
8565MCB37	85	65	M12	37

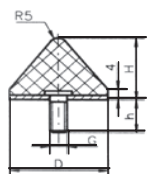

DATA SHEET MCB 2011. Max compression load in Kg deflection in mm.

This information is for guidance only. Customers are recommended to contact us for further technical information on products and applications. We reserve the right to alter specifications or withdraw products without notice.