

# Female Flat Buffer

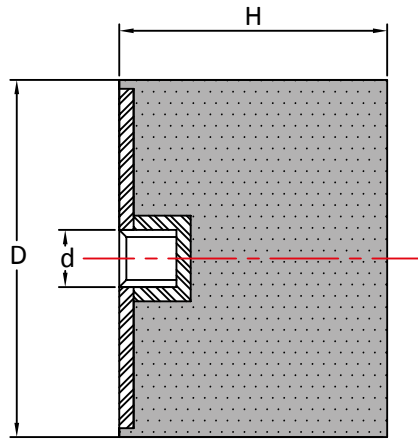

Part No	D x H	d	45° Shore A	60° Shore A	70° Shore A	mm
1510FFB04	15 x 10	M4	26.5	35.0	47.0	2.5
1515FFB04	15 x 15	M4	21.0	30.5	42.5	3.75
1520FFB04	15 x 20	M4	15.5	23.0	32.0	5.0
2015FFB06	20 x 15	M6	34.5	52.5	72.5	3.75
2020FFB06	20 x 20	M6	26.5	39.5	54.5	5.0
2025FFB06	20 x 25	M6	27.5	41.5	57.5	6.25
2030FFB06	20 x 30	M6	22.0	31.5	44.5	7.5
2515FFB06	25 x 15	M6	69.0	106.0	148.5	3.75
2517FFB06	25 x 17	M6	67.5	101.0	140.0	4.25
2520FFB06	25 x 20	M6	64.5	95.0	128.5	5.0
2525FFB06	25 x 25	M6	45.5	67.5	94.0	6.25
2530FFB06	25 x 30	M6	39.5	59.5	79.0	7.50
3015FFB08	30 x 15	M8	90.0	134.5	188.0	3.75
3017FFB08	30 x 17	M8	83.0	129.5	175.0	4.25
3020FFB06	30 x 20	M6	77.0	116.0	158.5	5.0
3025FFB08	30 x 25	M8	55.5	84.0	119.0	6.25
3030FFB08	30 x 30	M8	53.5	79.0	109.0	7.5
3040FFB08	30 x 40	M8	54.5	80.0	111.0	10.0
4020FFB08	40 x 20	M8	158.0	238.0	327.0	5.00
4020FFB10	40 x 20	M10	158.0	238.0	327.0	5.00
4025FFB08	40 x 25	M8	139.0	208.0	287.0	6.25
4027FFB08	40 x 27	M8	125.5	186.5	255.7	6.75
4028FFB10	40 x 28	M10	127.0	188.0	257.0	7.00
4030FFB08	40 x 30	M8	119.0	178.0	248.0	7.50
4030FFB10	40 x 30	M10	119.0	178.0	248.0	7.50
4035FFB08	40 x 35	M8	105.0	156.0	218.0	8.75
4040FFB08	40 x 40	M8	99.0	148.0	203.0	10.00
5021FFB10	50 x 21	M10	352.0	525.0	723.0	5.00

Part No	D x H	d	45° Shore A	60° Shore A	70° Shore A	mm
5025FFB10	50 x 25	M10	307.0	455.0	629.0	6.25
5030FFB12	50 x 30	M12	252.0	371.0	515.0	7.50
5040FFB10	50 x 40	M10	173.0	257.0	356.0	10.00
5045FFB10	50 x 45	M10	153.0	228.0	317.0	11.25
5050FFB10	50 x 50	M10	139.0	208.0	287.0	12.50
6025FFB10	60 x 25	M10	525.0	683.0	1079.0	6.25
6040FFB10	60 x 40	M10	386.0	574.0	780.0	10.0
6040FFB12	60 x 40	M12	386.0	574.0	780.0	10.0
6045FFB12	60 x 45	M12	347.0	515.0	713.0	11.25
6050FFB12	60 x 50	M12	307.0	455.0	629.0	12.5
7040FFB10	70 x 40	M10	505.0	752.0	1040.0	10.0
7040FFB12	70 x 40	M12	505.0	752.0	1040.0	10.0
7045FFB10	70 x 45	M10	446.0	663.0	890.0	11.25
7045FFB12	70 x 45	M12	446.0	663.0	890.0	11.25
7050FFB10	70 x 50	M10	396.0	594.0	822.0	12.5
7050FFB12	70 x 50	M12	396.0	594.0	822.0	12.5
7525FFB12	75 x 25	M12	900.0	1365.0	1880.0	6.25
7540FFB12	75 x 40	M12	545.0	980.0	1337.0	10.00
7550FFB12	75 x 50	M12	505.0	752.0	1040.0	12.50
7555FFB12	75 x 55	M12	435.0	653.0	900.0	13.75
8040FFB14	80 x 40	M14	743.0	1109.0	1535.0	10.00
8080FFB14	80 x 80	M14	416.0	614.0	842.0	20.00
10030FFB16	100 x 30	M16	1821.0	3648.0	4920.0	7.50
10040FFB16	100 x 40	M16	1633.0	2425.0	3316.0	10.00
10050FFB16	100 x 50	M16	1386.0	2064.0	2850.0	12.50
10055FFB16	100 x 55	M16	1277.0	1930.0	2624.0	13.75
10060FFB16	100 x 60	M16	1139.0	1683.0	2322.0	15.00
100100FFB16	100 x 100	M16	644.0	955.0	1317.0	25.00

Max compression load in Kg deflection in mm.

This information is for guidance only. Customers are recommended to contact us for further technical information on products and applications.

We reserve the right to alter specifications or withdraw products without notice.